

LAYOUT PLAN OF GOVERNMENT LAND IN SY.NO. 343/P AT AMEENPUR (V & M), SANGAREDDY DIST.

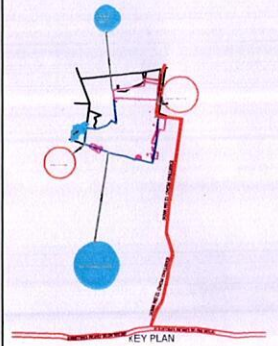
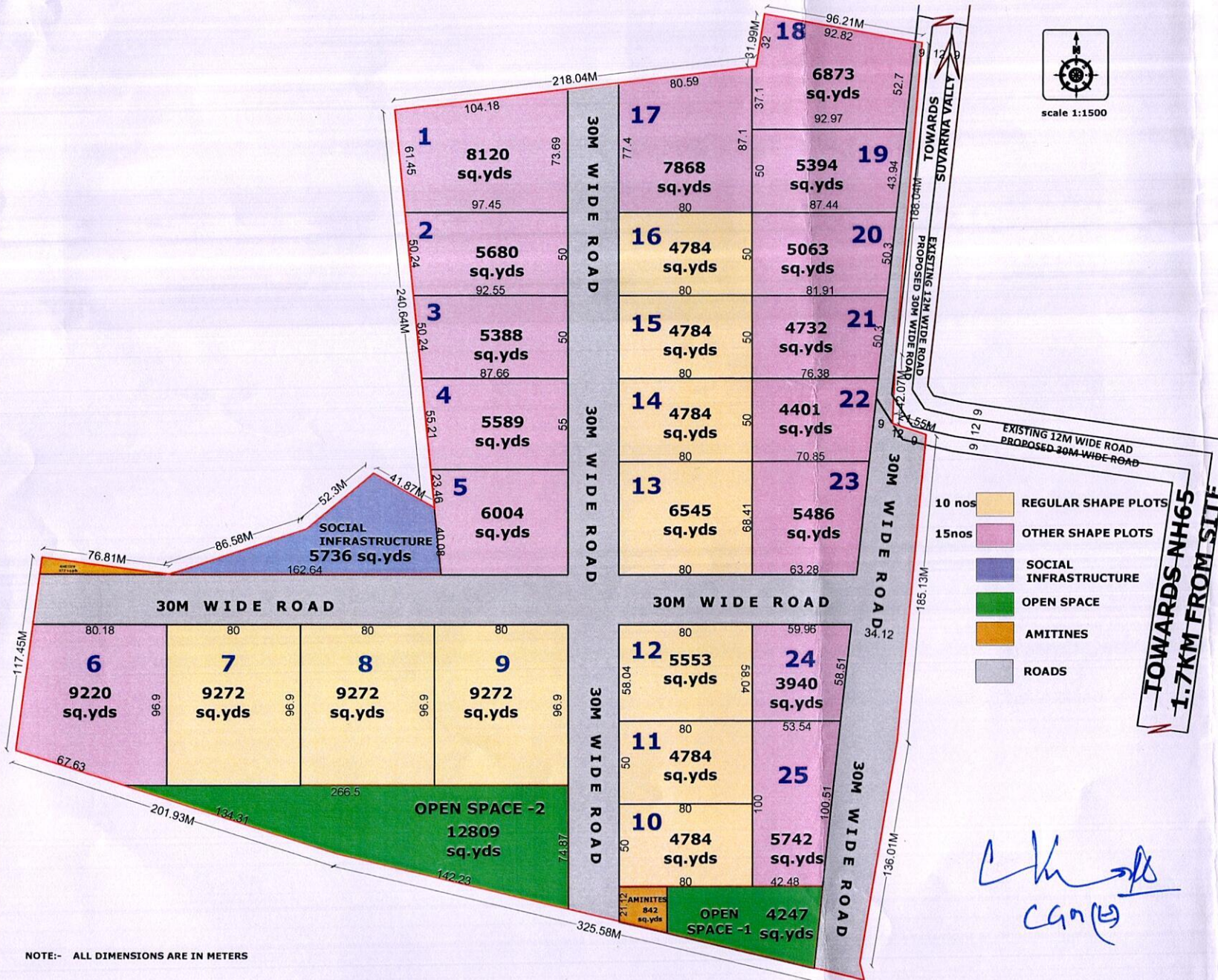

LAYOUT BOUNDARY

PROPOSED ROADS

EXISTING ROADS

TOTAL AREA	46.91 AC	100.00 %
TOTAL PLOTTED AREA	31.68 AC	67.53 %
ROAD AREA	10.25 AC	21.85 %
OPEN AREA		
1.OPEN SPACE	3.52 AC	7.50 %
2.SOCIAL INFRASTRUCTURE	1.19 AC	2.54 %
AMINITIES	0.27 AC	0.58 %



TELANGANA STATE INDUSTRIAL INFRASTRUCTURE CORPORATION LTD  
(A GOVT. OF TELANGANA STATE UNDERTAKING)

*Chandra*  
CAG (19)

NOTE:- ALL DIMENSIONS ARE IN METERS